

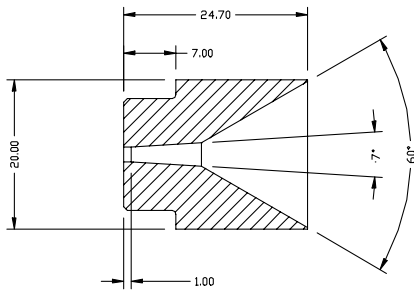

## EXTRUSION TIPS & DIES

Please find below a selection of Extrusion Tips and Dies. If your particular requirement is not illustrated, please contact us for further information.



- Item 1 - Tungsten Carbide Extrusion die - Type D 1200 / CT
- Item 2 - Hardened Steel Extrusion die - Type D 1200 / AX

- Item 1 - Extrusion Tip in Hardened Steel - Type G 1170 / AX
- Item 2 - Extrusion Tip with Tungsten Insert - Type G 1170 / AT
- Item 3 - Extrusion Tip with PCD Insert - Type G 1170 / PCD

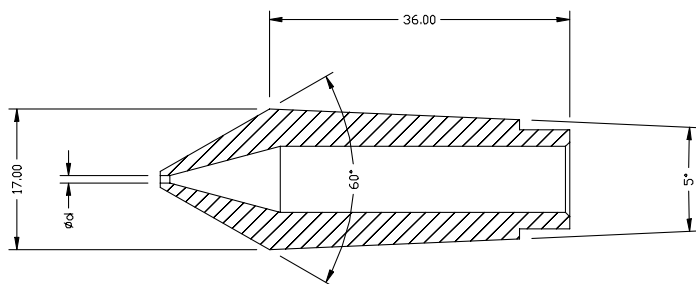

We currently produce several types of extrusion tips & dies. They can be produced in Tool Steel, Stainless Steel, with Tungsten Carbide insert and also with PCD or Diamond insert.